

MODEL
TL100 TRILIFTER
50 TON (45 TONNE)



THE ULTIMATE RIGGING MACHINE



P.O. Box 506 Dixon, IL 61021 Phone: +1-815-288-7626 Fax: +1-815-288-7634
riggers@riggers.com www.riggers.com

TL100 STANDARD EQUIPMENT

ENGINE:

GM 4.3L, V6
105 hp (78 Kw)

HYDRAULIC RESERVOIR:

280 gallons (1060 liters)

CONTROL SYSTEM:

CARL (Computer Assisted Remote Lifting) Control System. Lift Height, Boom Extension, Pressure, Counterweight Load Pin. Automatic Shutdown for overload conditions. Large easy to read display screen with push button navigation and dial adjustment.

CONTROLS:

Separate controls for each function. Combination of foot pedal, joystick, and push button controls allows for multiple functions to be performed at the same time.

DRIVE:

Poclain MK35 drive motors (qty. 2).

Electronic Control of travel speed.

Posi Drive Feature for increased traction.

WHEELS:

Front: qty. (4)

Diameter: 28" (711 mm)

Width: (2) @ 16" (406 mm) and (2) @ 12" (305 mm)

Rear: qty. (4)

Diameter: 22" (559 mm)

Width: 12" (305 mm)

Replaceable polyurethane composition

STEERING:

47 degree steering of rear wheels.

OSCILLATING REAR STEERING BOX:

Keeps all steering wheels in contact with ground.

OUTSIDE TURNING RADIUS:

Counterweight Retracted: 20'0" (6,096 mm)

Counterweight Extended: 25'1" (7,645 mm)

TRAVEL SPEED:

0.0 - 3.64mph (5.85 km/h)

GRADABILITY:

Unloaded maximum grade is 20%

Loaded maximum grade is 8%

GROUND BEARING PRESSURE:

Loaded Front Tires: 520 psi maximum (36.6 kg/cm²)

Unloaded Rear Tires: 507 psi maximum (35.6 kg/cm²)

TELESCOPING COUNTERWEIGHT:

Standard counterweight section telescopes 5' (1,524 mm) using (2) hydraulic cylinders.. Push button control.

LIFT CYLINDERS:

Qty. (4) double acting lift cylinders capable of lifting and lowering with a full load.

Safety holding valves installed on all cylinders.

Spherical bearings ensure constant alignment with the boom.

Front: Qty. (2) 4-stage cylinders

Rear: Qty. (2) 3-stage cylinders

BOOM TELESCOPE CYLINDERS:

Twin double-acting single-stage cylinders capable of telescoping the boom in and out with a full load.

Safety holding valves are installed on both cylinders.

LIFTING EYES:

Qty. (2) located on corners of boom with 25 ton (22.5 tonne) capacity each.

WEIGHTS:

Base Machine: 32,000 lbs. (18,387 kg)

Counterweights: 22,500 lbs. (10,215 kg) total
Qty. (6) 3,750 lbs. (1,702 kg) each

Fork Buttress: 1,300 lbs. (590 kg)

50 ton Forks: 5,900 lbs. total (1,702 kg)

65 ton Spinner: 350 lbs. (159 kg)

Spreader Bar: 1,150 lbs. (522 kg)

Jib: 5,500 lbs. (2,497 kg)

Riggers Boom: 6,400 lbs. (2,906 kg)

COUNTERWEIGHTS:

Fork Loops installed for ease of handling.

TIE DOWN / LIFTING EYES:

Tie down / lifting eyes installed for securing unit during transport and for lifting of the unit.

OTHER STANDARD FEATURES:

Back up alarm, horn, strobe light, operator seat complete with safety belt.

TL100 OPTIONAL EQUIPMENT

FORKLIFT ATTACHMENT



Turn the TriLifter into a 50 ton forklift with the addition of forks and a buttress.

65 TON SPINNER



Rotate loads 360° with the 65 ton spinner. The modular spinner can also be connected to a hydraulic gantry lifting link.

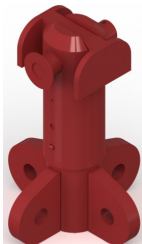

SPREADER BAR

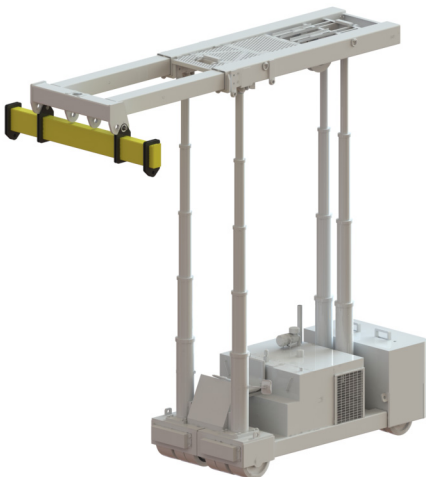

The 25 ton Spreader Bar increases the width of your unit and also assists in lifting offset loads.

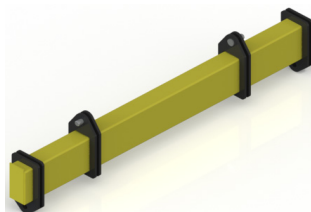

RIGGERS BOOM



With the NEW Riggers Boom option, the TriLifter can reach an amazing 35' (10.6 m) with 25 tons!

Vertical mast fork lifts have nothing on the TriLifter!

RADIO REMOTE CONTROL



Operate the TriLifter from a Radio Remote instead of the operators seat. Allow your operator the optimal view of every lift. Emergency stop button standard.

JIB



Increase the range of your TriLifter to 18' (5.486 m) from the front of your unit. The pin-on jib extends with the power boom.

TL100 DIMENSIONS

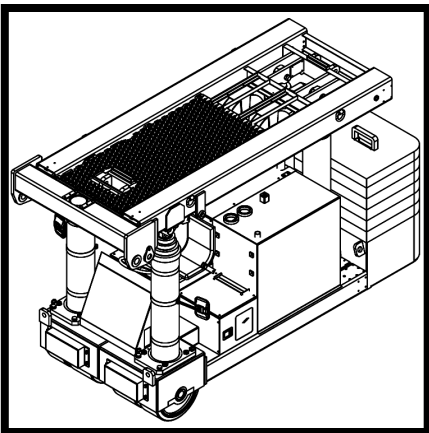
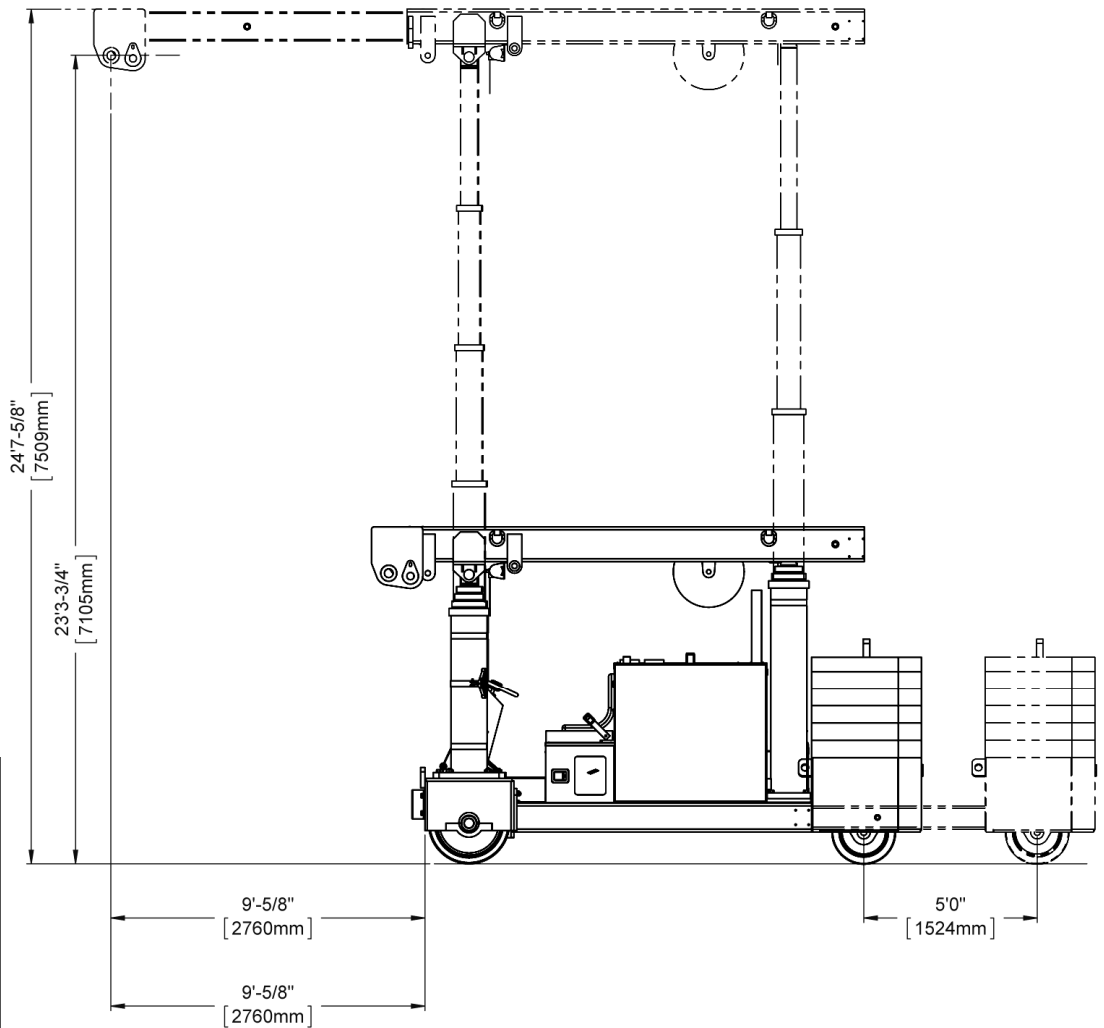
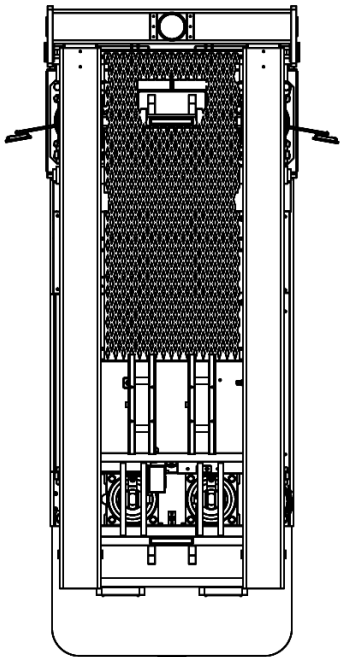
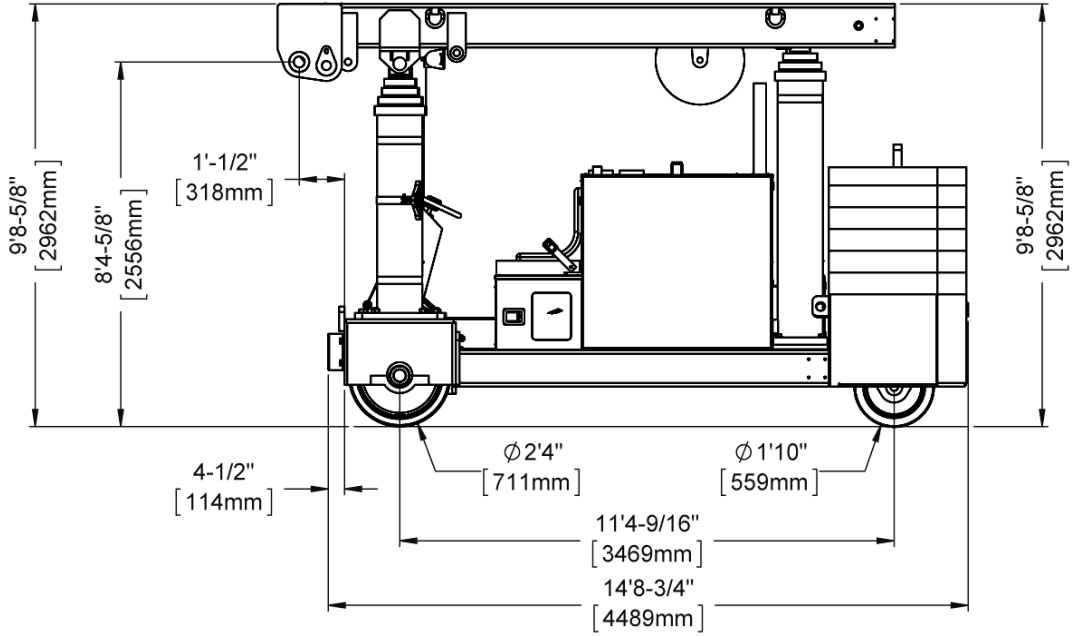
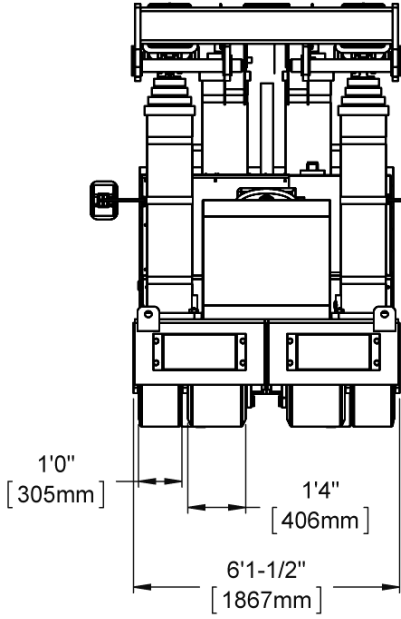

TL100 LOAD CHARTS

TL100 LIFTING CAPACITY FROM LIFTING EYES

BOOM EXTENSION INCHES	COUNTERWEIGHT IN POUNDS	COUNTERWEIGHT OUT POUNDS
36	83,600	101,000
48	67,200	81,800
60	56,000	68,200
72	47,800	58,400
84	41,600	51,000
96	36,800	45,200
108	33,000	40,600

TL100 LOAD CHARTS—METRIC

TL100 LIFTING CAPACITY FROM LIFTING EYES

BOOM EXTENSION MILLIMETERS	COUNTERWEIGHT IN KILOGRAMS	COUNTERWEIGHT OUT KILOGRAMS
914	37,920	45,810
1219	30,480	37,100
1524	25,400	30,935
1,829	21,680	26,490
2,134	18,870	23,130
2,348	16,692	20,500
2,743	14,965	18,415

TL100 DIMENSIONS WITH FORKS

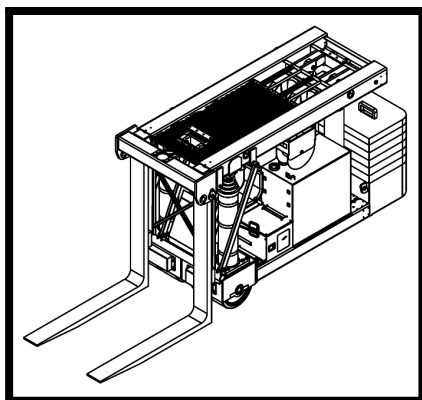
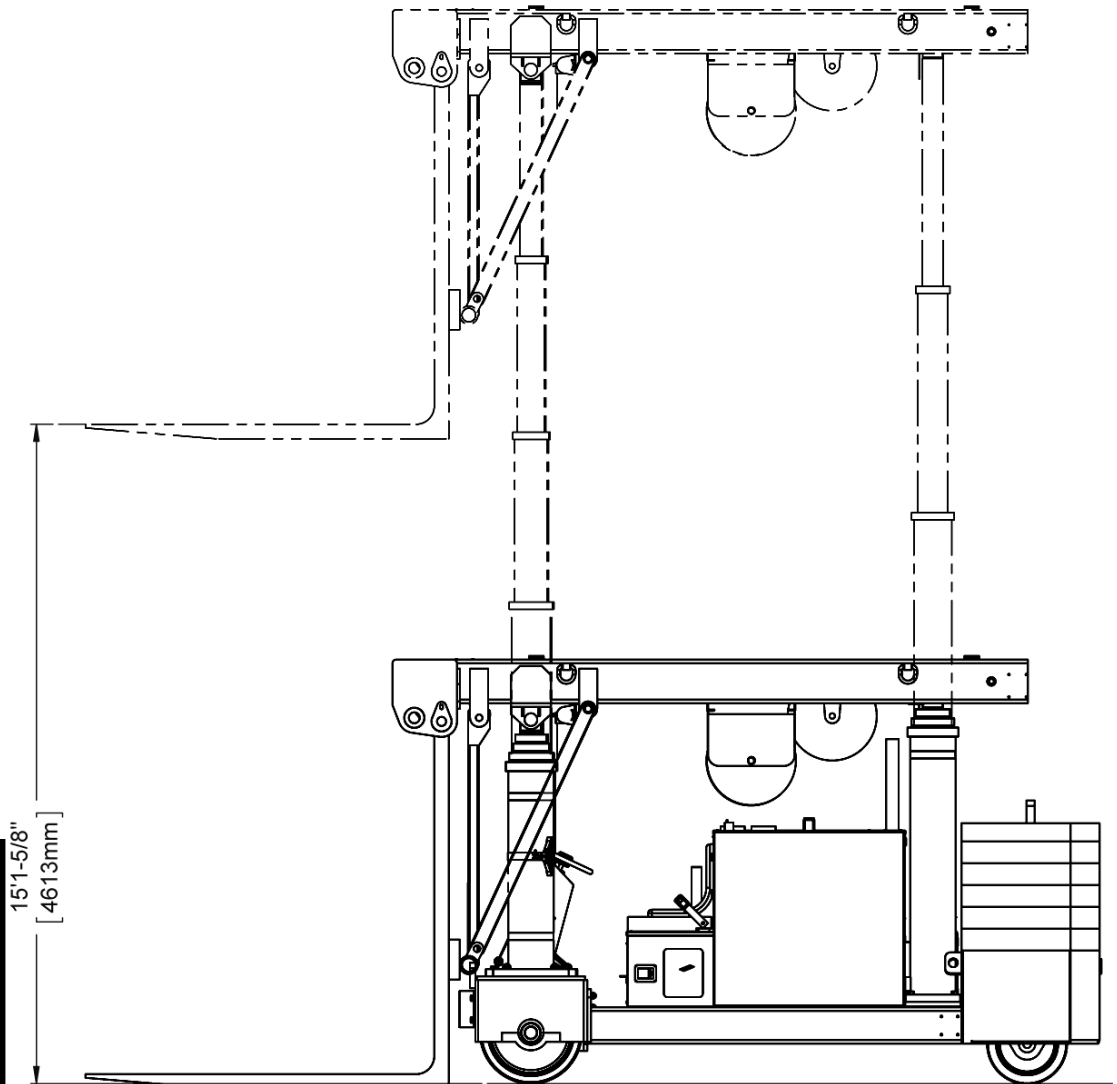
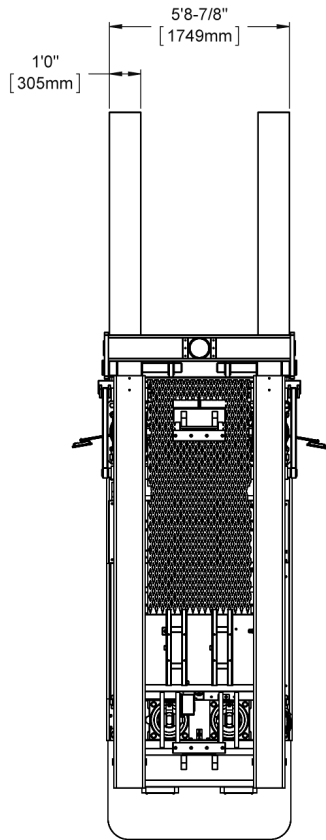
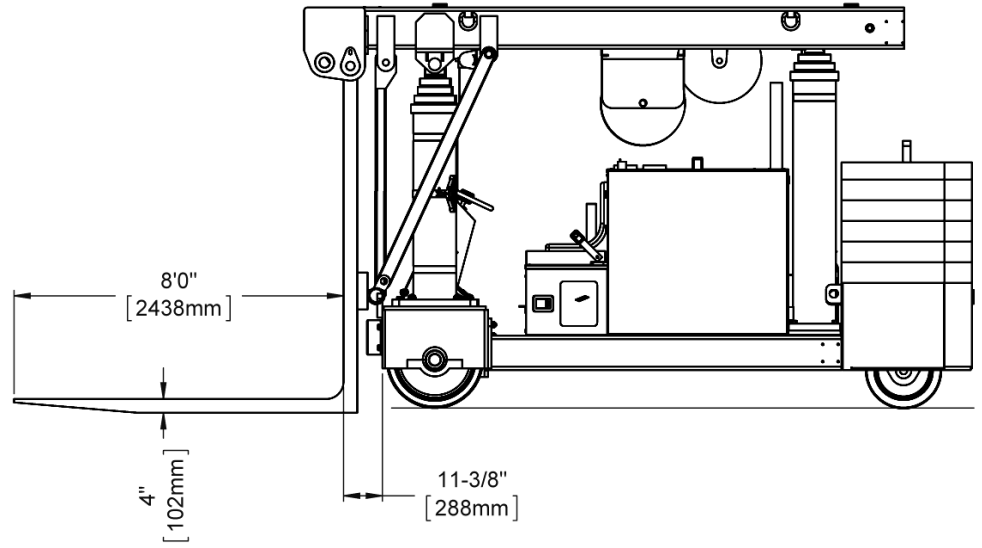
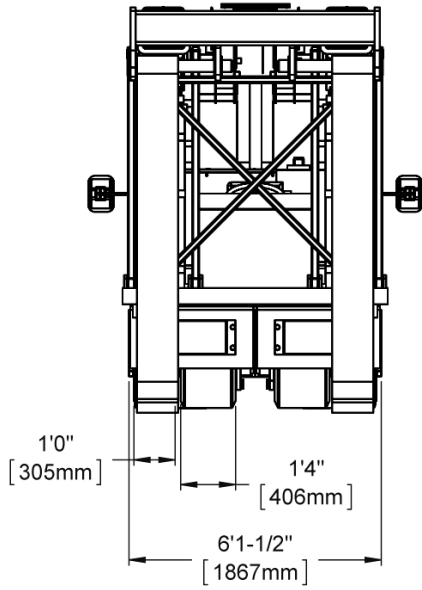

TL100 LOAD CHARTS WITH FORKS

TL100 LIFTING CAPACITY FROM 50 TON FORKS

LOAD CENTER INCHES	COUNTERWEIGHT IN POUNDS	COUNTERWEIGHT OUT POUNDS
24	80,200	100,000
36	64,000	66,000
48	50,000	50,000
60	40,000	40,000
72	33,000	33,000
84	28,000	28,000
96	24,000	24,000

TL100 LOAD CHARTS WITH FORKS—METRIC

TL100 LIFTING CAPACITY FROM 45 TONNE FORKS

LOAD CENTER MILLIMETERS	COUNTERWEIGHT IN KILOGRAMS	COUNTERWEIGHT OUT KILOGRAMS
610	36,375	45,355
914	29,030	29,935
1,219	22,670	22,670
1,524	18,140	18,140
1,829	14,965	14,965
2,134	12,700	12,700
2,438	10,885	10,885

TL100 DIMENSIONS WITH RIGGERS BOOM

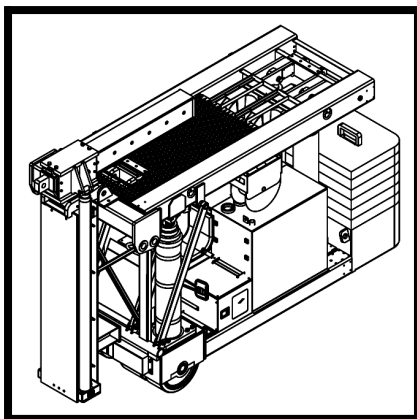
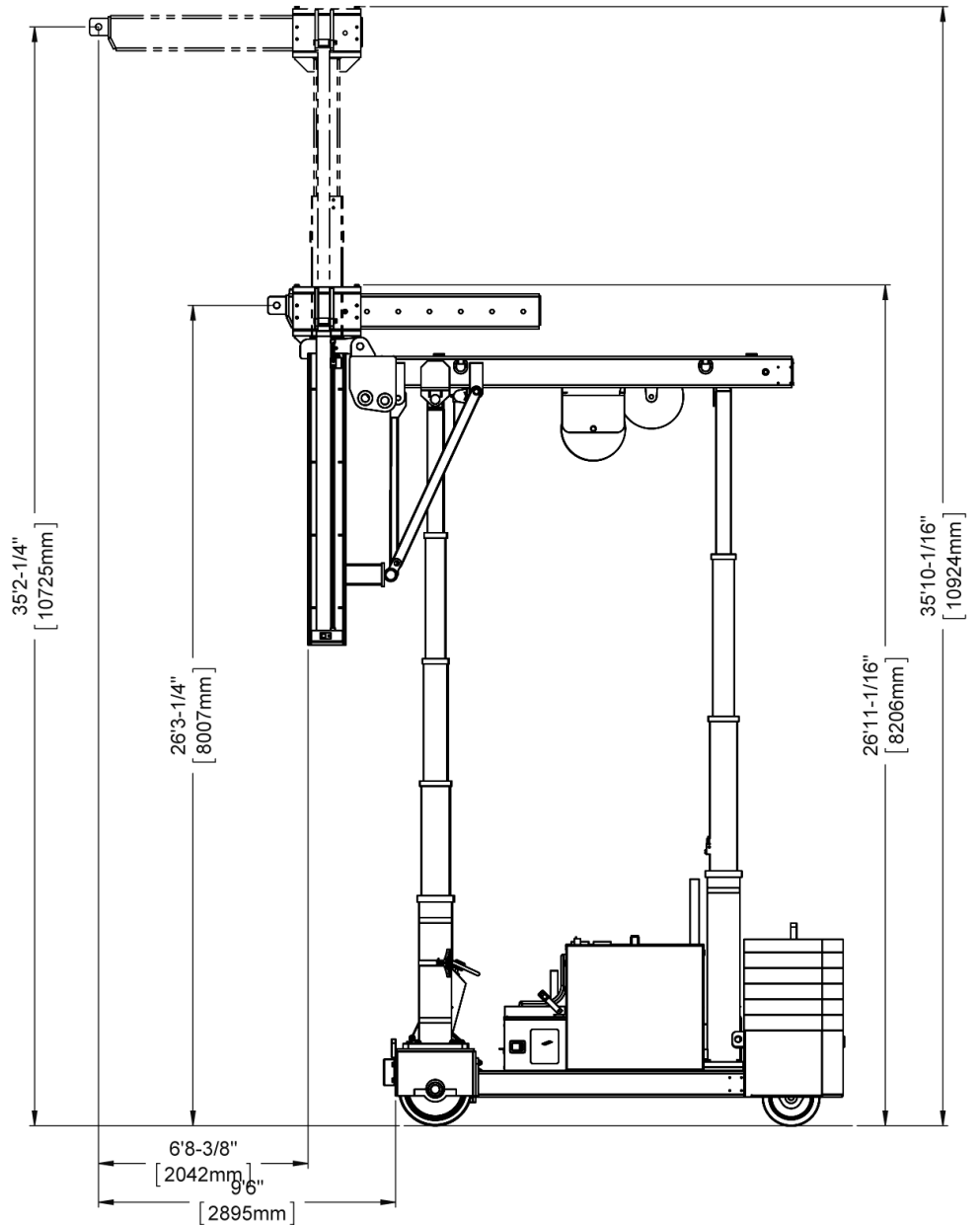
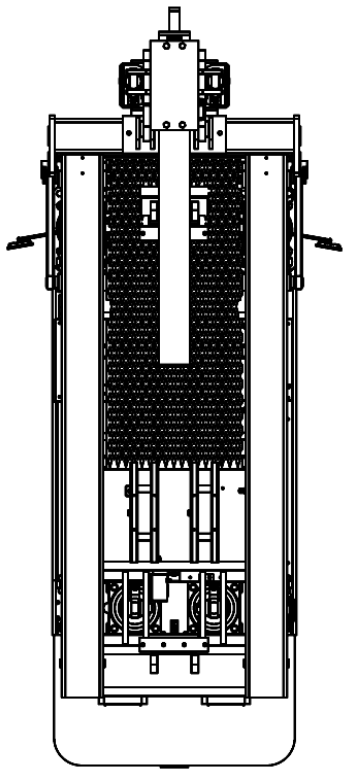
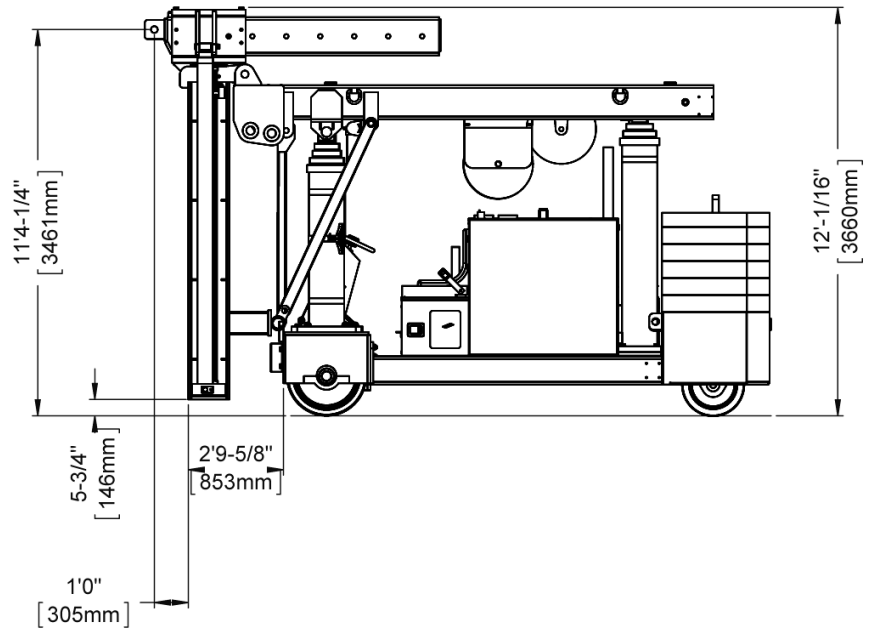
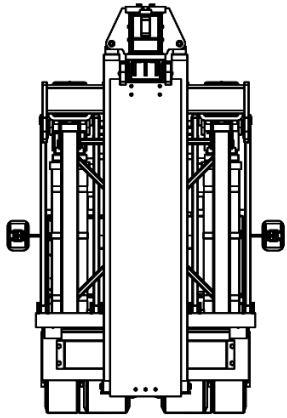

TL100 LOAD CHARTS WITH RIGGERS BOOM

TL100 LIFTING CAPACITY FROM RIGGERS BOOM

BOOM EXTENSION FROM FACE INCHES	COUNTERWEIGHT IN POUNDS	COUNTERWEIGHT OUT POUNDS
12	50,000	50,000
20	50,000	50,000
32	50,000	50,000
44	42,310	50,000
56	38,660	47,990
68	34,340	42,665
80	30,960	38,545

TL100 LOAD CHARTS WITH RIGGERS BOOM—METRIC

TL100 LIFTING CAPACITY FROM RIGGERS BOOM

BOOM EXTENSION FROM FACE MILLIMETERS	COUNTERWEIGHT IN KILOGRAMS	COUNTERWEIGHT OUT KILOGRAMS
305	22,680	22,680
508	22,680	22,680
813	22,680	22,680
1,118	19,190	22,680
1,422	17,535	21,765
1,727	15,575	19,350
2,032	14,040	17,480

TL100 DIMENSIONS WITH JIB

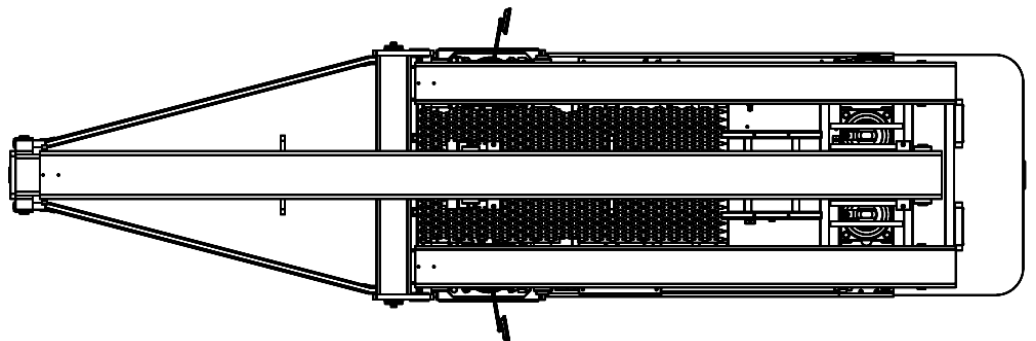
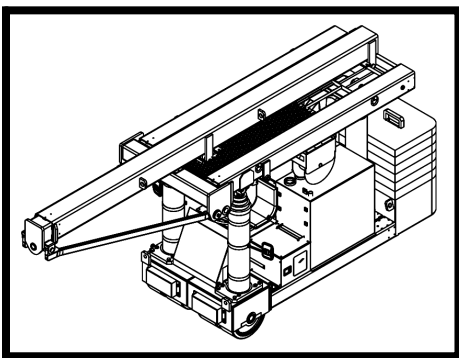
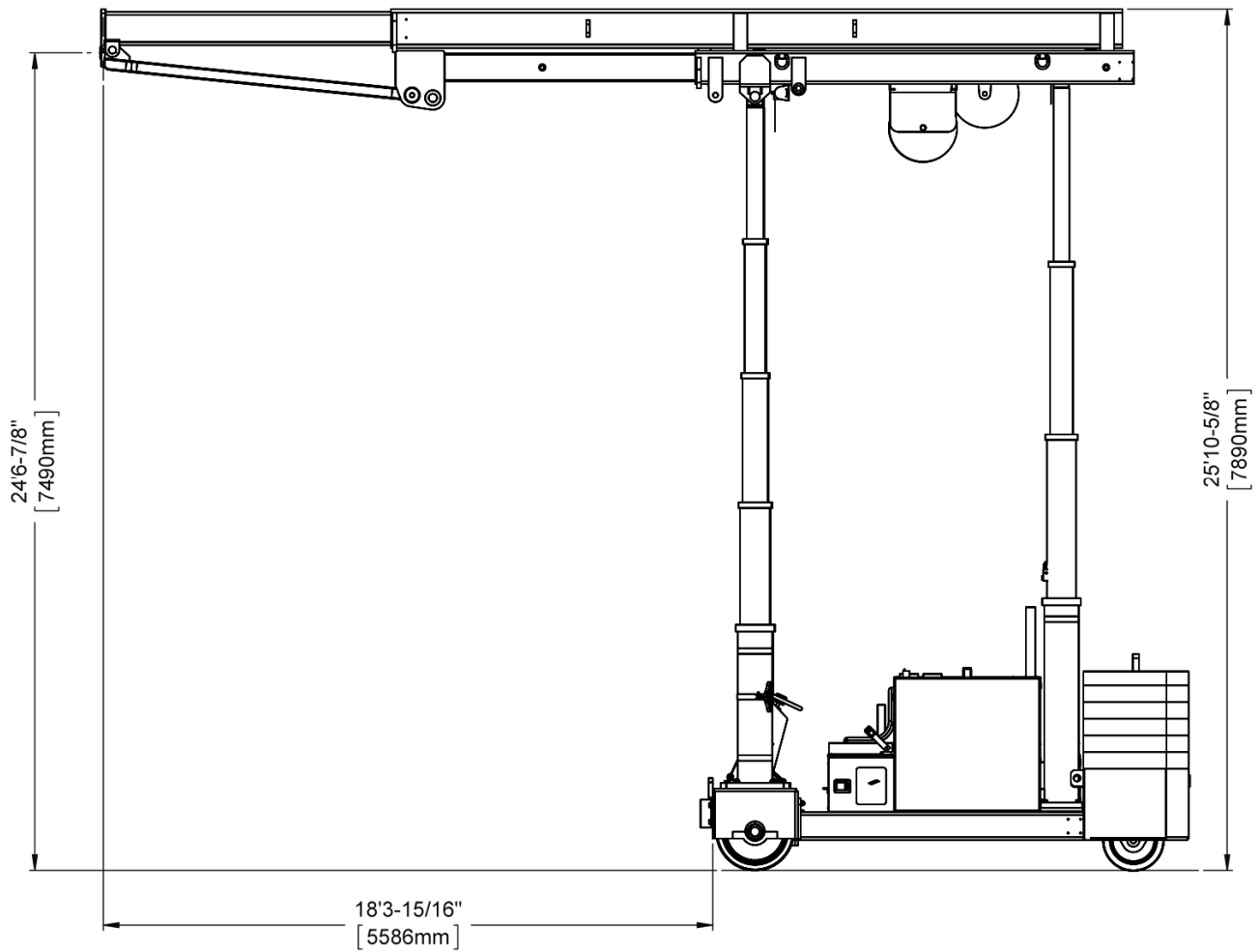
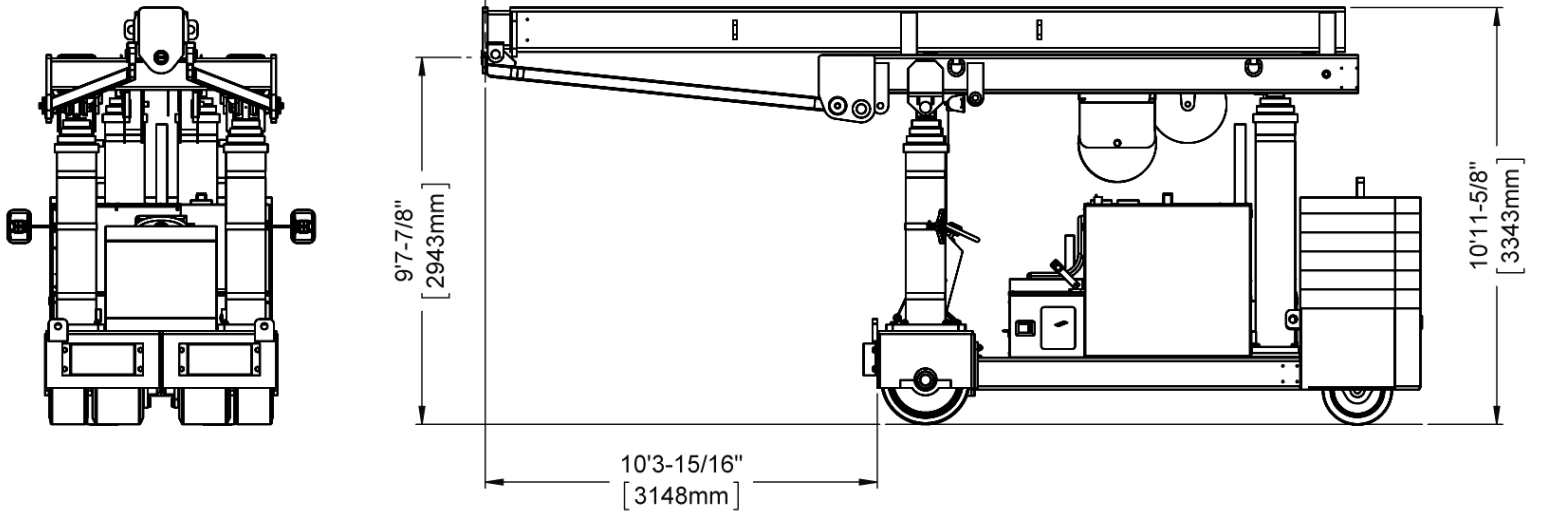

TL100 LOAD CHARTS WITH JIB

TL100 LIFTING CAPACITY FROM JIB

BOOM EXTENSION INCHES	JIB EXTENSION INCHES	COUNTERWEIGHT IN POUNDS	COUNTERWEIGHT OUT POUNDS
12	124	27,765	34,680
24	136	25,095	31,450
36	148	22,825	28,700
48	160	20,875	26,270
60	172	19,175	24,160
72	184	17,690	22,305
84	196	16,375	20,670
96	208	15,205	19,210
108	220	14,155	17,900

TL100 LOAD CHARTS WITH JIB—METRIC

TL100 LIFTING CAPACITY FROM JIB

BOOM EXTENSION MILLIMETERS	JIB EXTENSION MILLIMETERS	COUNTERWEIGHT IN KILOGRAMS	COUNTERWEIGHT OUT KILOGRAMS
	3,150		
610	3,454	11,380	14,265
914	3,759	10,350	13,020
1,219	4,064	9,465	11,915
1,524	4,369	8,700	10,955
1,829	4,674	8,025	10,115
2,134	4,978	7,425	9,375
2,438	5,283	6,895	8,710
2,743	5,588	6,420	8,120